

# IW16 UNDERWATER IMPACT WRENCH

# STANLEY®



## SPECIFICATIONS

|                              |                                   |
|------------------------------|-----------------------------------|
| <b>Capacity</b>              | 1" Square Drive                   |
| <b>Torque</b>                | 500 -2500 ft lbs /<br>680-3400 Nm |
| <b>Flow Range</b>            | 7-12 gpm / 26-45 lpm              |
| <b>Working Pressure</b>      | 1500-2000 psi /<br>105-140 bar    |
| <b>Full Relief Setting</b>   | 2250 psi / 155 bar                |
| <b>Weight</b>                | 26 lbs / 12 kg                    |
| <b>Length</b>                | 15" / 38 cm                       |
| <b>Width</b>                 | 4.5" / 11 cm                      |
| <b>Hydraulic Ports</b>       | -8 SAE O-ring                     |
| <b>Connect Size and Type</b> | 3/8" Male Pipe Adapter            |
| <b>Couplers</b>              | (See Ordering Information)        |
| <b>Hose Whips</b>            | No (See Accessories)              |



The Stanley **IW16** is a heavy duty 1" square drive impact wrench designed for the toughest underwater bolting applications. Powered by a Stanley integral Hyrevz motor, the **IW16** has a durable swing hammer impact mechanism with adjustable impact intensity from 500 to 2500 ft lbs (680 to 3400 Nm) of torque. Designed to run from a wide range of hydraulic circuits. "D" style grip handle with multi-position assist handle and hi-visibility yellow paint is standard.

## FEATURES

- Integral Stanley Hyrevz gear motor produces high torque
- Stainless Steel spools and fasteners
- Forward-Reverse with variable speed
- "D" style grip handle with inside trigger
- Feathering on/off trigger for precise control
- Adjustable impact intensity
- 2500 ft lbs/3400 Nm of maximum impact torque
- Durable swing hammer mechanism
- Cast-in lifting eye

# IW16 UNDERWATER IMPACT WRENCH

**STANLEY**<sup>®</sup>

## ORDERING INFORMATION

### PART NUMBER

**IW16350** Impact Wrench, Underwater, 1" Square Drive, with couplers, CE

### ACCESSORIES

|              |  |
|--------------|--|
| <b>03971</b> | Flush-Face Coupling Set, 3/8" NPT            |
| <b>03974</b> | Flush-Face Coupling Set, 1/2" NPT            |
| <b>06830</b> | Hose Whip 18" long, -8 SAE x 1/2" NPT        |
| <b>31848</b> | Dual Hose, 50' x 1/2", with couplers         |
| <b>31972</b> | Dual Hose, 25' x 1/2", with couplers         |
| <b>58633</b> | Twinned Hose, 25' x 1/2", with couplers      |
| <b>58634</b> | Twinned Hose, 50' x 1/2", with couplers      |
| <b>31203</b> | Extension, 10", 1" Drive                     |
| <b>33276</b> | Socket Retainer Pin, 1" Square Drive Socket  |
| <b>33277</b> | Socket Retainer Ring, 1" Square Drive Socket |

When hydraulic hose exceeds 100' (30.4 m) in length, increase I.D. of both pressure and return hose. For more information, consult Stanley Hydraulic Tools.

### IMPORTANT

To fill out a Product Warranty Recording form and for information on your warranty visit [stanleyhydraulic.com](http://stanleyhydraulic.com) and select the Warranty tab.

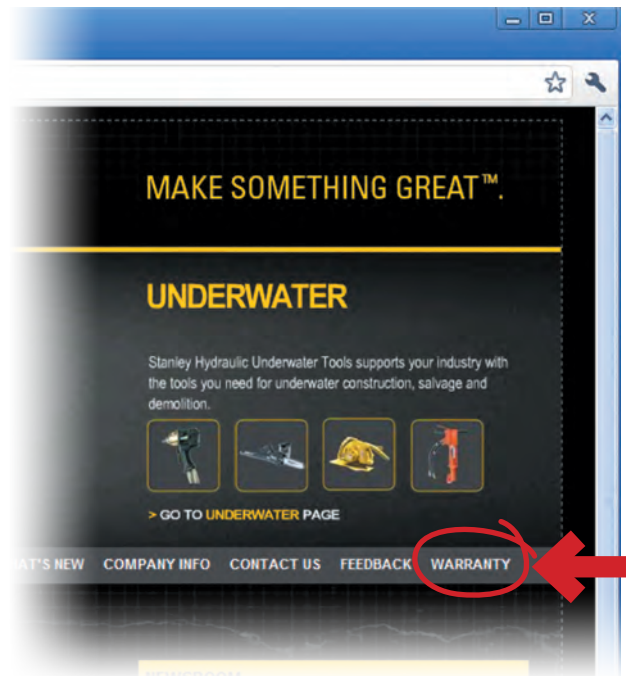

**Note:** The warranty recording form must be submitted to validate the warranty.

All Stanley Hydraulic Tools, parts, accessories and allied equipment are subject to design improvements, specifications and price changes at any time without notice and with no obligation to units already sold. Weights, dimensions and operating specifications listed herein are subject to change without notice. Where specifications are critical to your applications, please consult Stanley Hydraulic Tools.

**STANLEY**

Stanley Hydraulic Tools | 3810 SE Naef Road | Milwaukie, Oregon 97267 | +01.503.659.5660 | 800.972.2647 | [www.stanleyhydraulic.com](http://www.stanleyhydraulic.com)